

# 170 RUSSELL

Venue Production Specs. Updated 12/2/21

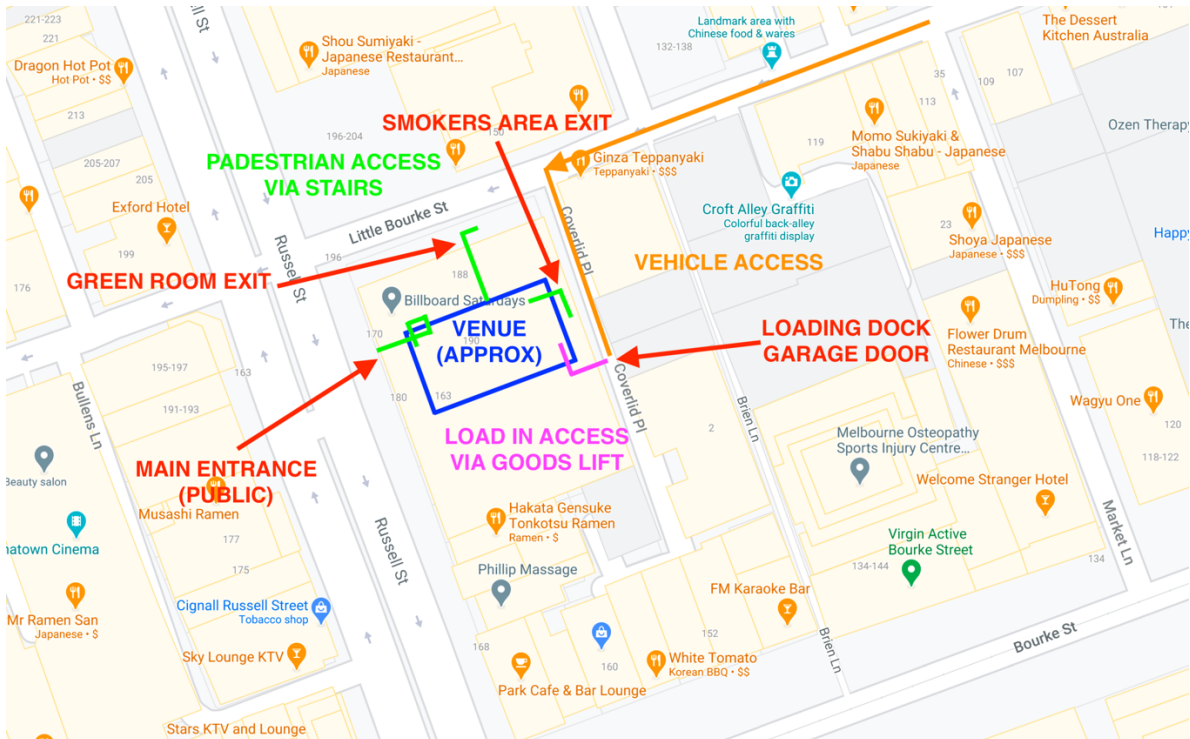

## Address

Main Entrance: 170 Russell St, Melbourne

Loading Dock: Coverlid Place, Melbourne (off Little Bourke St)

## Contacts

Venue Manager: Taryn Walton, [taryn@170russell.com](mailto:taryn@170russell.com), +61 433 042 132

Production Manager: Joel Cairns, [production@170russell.com](mailto:production@170russell.com), +61 412 297 964

Booking Contact: Ben Thompson, [ben@170russell.com](mailto:ben@170russell.com), +61 488 770 208

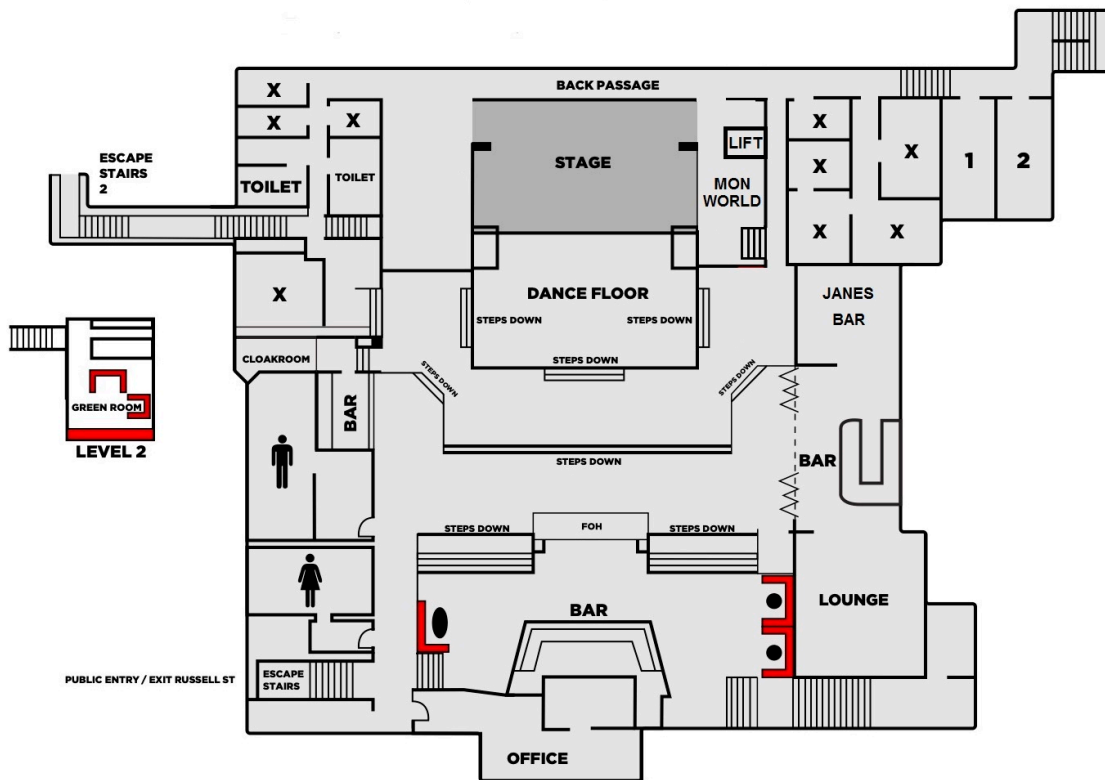

## Access

Load in access is via Coverlid Place which is off Little Bourke St. Anything larger than a 3T truck may need to be loaded and unloaded from Little Bourke St. Please park vehicles as close to the left hand side of Coverlid Place as possible. There is a garage door that opens up for access to a goods lift down to stage level on stage left. The goods lift is strictly for equipment only – no persons are permitted to ride in it.

Goods lift dimensions are:

1600mm deep x 830mm wide x 1300mm high

Maximum capacity is 250kg

Any equipment that will not fit in the goods lift will need to be carried down the main entrance stairs off Russell St.

Pedestrian access for load in/out is via the smokers area door onto Coverlid place and then down the stairs into the venue.

Standard load in time for the majority of shows is 2pm. Load in can be scheduled by prior arrangement as early as 12pm however this will incur a cost of \$35+gst/hour each for the Venue Manager and any venue production staff.

## Case Storage

There is a small amount of wing space stage right for cases, usually enough for backline cases for main act and support. Arrangements can be made for storage of more empty cases (for LX floor packs, etc) in Janes Bar or Janes Lounge, however this might not be easily accessible during the show.

The walkway behind the back LED screen on stage must be kept completely clear at all times.

## House Technicians

Every show has both an audio and lighting tech rostered on.

The audio tech is responsible for assisting with patching any touring equipment into the house system, assist with patching stage, and to operate monitors on the house console if required.

If an operator is required to mix FOH there will need to be a second audio tech booked for the show.

The house lighting tech is responsible for assisting with patching any touring lighting and video equipment into the house system, operating the venue architectural lighting, and to assist with simple operations such as a static lighting wash for support acts and displaying single images or video loops on the house screens.

They are available to operate lights for the show at cost.

House VJ can also be provided at cost.

House technicians are not responsible for loading and unloading of trucks, or any setup and packdown of touring equipment. Please make sure you have adequate labour for this.

## Power

The following is available for touring production.

2x spare 32a Wilco for LX/VX on the back of the stage right bulkhead

1x spare 32a Wilco for LX/VX on the stage left mezzanine level

1x spare 32a Wilco for AX in the pit at monitors (stage left)

There is a 3 phase distro in the house audio rack at monitors for standard 240v touring audio and for backline/stage power (pre run power drops USL, USC, USR, DSL, DSR)

## Stage Dimensions

Width at front of stage/midstage bulkheads: 8670mm

Depth to rear screen: 6700mm

Stage height: 900mm

Trim height stage to proscenium: 4280mm

Trim height stage to bottom of flown truss at full trim: 4680mm

## Risers

4x 2.4m x 1.2m DQ style Risers

16x each of 300mm, 600mm, 750mm, 900mm static legs.

8x single 300mm rolling legs

4x dual 300mm rolling legs (to join 2 riser sections together)

There is also a fly in banner bar for backdrops

Width: 8000mm

Height at full trim: 5000mm

## FOH System

Digidesign Profile. FOH rack with 5x engines. Stage rack at monitors with 48x mic/line inputs, 16x line outs, and 4x AES outs

Main PA: 8x D&B J8 (4 per side)

Subs: 4x D&B B22 (under stage)

Centre Downfill: 2x Y8 (**Note: Due to renovations these are currently set up as infill**)

Mid Delays: 2x Y10p

Rear Delays: 2x Y10p

Wing Fill: 2x E8

Amplifiers: 1x D80, 3x 30D

PA inputs are analogue from the stage and can be run as:

Left, Right, Sub, Centre Fill (all other delays are run off L/R)

## Monitor System

Digico SD8. Core 2. V 1280. 8x local mic/line inputs, 8x local line outputs, 4x AES inputs, 4x AES outputs

Madi Rack with 48x mic/line inputs, 16x line outputs

12x Nexo PS15 R1 wedges. 6x left, 4x right, 2x permanently hung as side fill

3x Nexo NX4x4 processing amplifiers. Software V 4\_20

## Patch

56 channel, 3 way passive split. 2x W4 headers for FOH and monitors.

If you require a separate split please provide your own W4 header.

5m W4 extension available.

4x Whirlwind 12 way drop boxes

1x Whirlwind 6 way drop box

## Microphones and DIs

2x e901

1x D6

1x Beta52a

7x e904

2x SM81

1x SM94

5x SM57

3x Beta57a

3x AR 133 Dis

2x 4 way Whirlwind passive Dis

**A note regarding covid19. We are currently asking that all vocalists provide their own vocal mics for shows given the obvious hygiene issues.**

**Please make sure all singers and audio techs are made aware of this, including all support acts.**

## Mic Stands

12x Short Boom

8x Tall Boom

4x Straight Round Base

### **Lighting Fixtures**

16x HY L600 Profile (Ayrton Ghibli Copy)  
12x HY L19 Wash (Ayrton Nando Copy)  
8x Robe DLX spot  
4x Martin Atomic 3000  
4x Nitec Blinder  
6x Selecon Acclaim ZoomSpot

### **Lighting Control**

1 x Chamsys magic Q system with 3x playback wings and 2x touchscreens.  
Software V 1.8.9.0  
DMX controlled via artnet

### **Video Screens**

Main Rear Screen  
3.9mm Pitch  
6mW x 3mH  
1440pixW x 720pixH

DJ Banner Screen – This can be attached to the bottom of the main screen or on rolling base plates.  
3.9mm Pitch  
6mW x 1mH  
1440pixW x 240pixH

Audience Screens  
4.8mm Pitch  
7 individual strips of 8 panels  
Each strip: 0.576mW x 4.608mD  
Each strip: 120pixW x 960pixH  
Whole roof: 4.032m x 4.608mD  
Whole roof: 840pixW x 960pixD

Rear "IMAG" Screens  
4.8mm Pitch  
2 panels of 5x2  
Each, 2.88m x 1.152m  
Each, 600pixW x 240pixH

Input at FOH: SDI, DVI, HDMI  
Input from Stage: SDI, HDMI  
Screen control from FOH running off Resolume 6

### **Network details**

ENTEC DATAGATE - 2.0.0.251

SUBNET: 255.0.0.0

HOUSE CONSOLE: 2.0.0.10

HOUSE MEDIA SERVER: 2.0.0.11

### **DJ Equipment**

1x DJM900 Nexus

4x CDJ3000

4x SL1200 Turntables (BYO Stylus)

1x 1200 x 600 x 900 on top of 1200 x 600 x 300 rolling riser

### **Recording**

There is currently no facilities for multitrack recording in house. There is however a spare output on the house audio split (BYO W4 header) or there is an MADI Aux on the Digico stage rack (BYO UB MADI or similar)

### **External Sub Hires**

The venue can organise quotes on external production (Backline, Radio Mics/IEMs, LX floor packages, etc.). This will all be quoted including delivery and labour for setup/packdown (unless discussed otherwise during the advance process). Once approved costs can be deducted from settlement.